

LOC	DIST	REV	DATE	BY	APPD
CM	00	H	16 JUL 2008	HMR	CJ

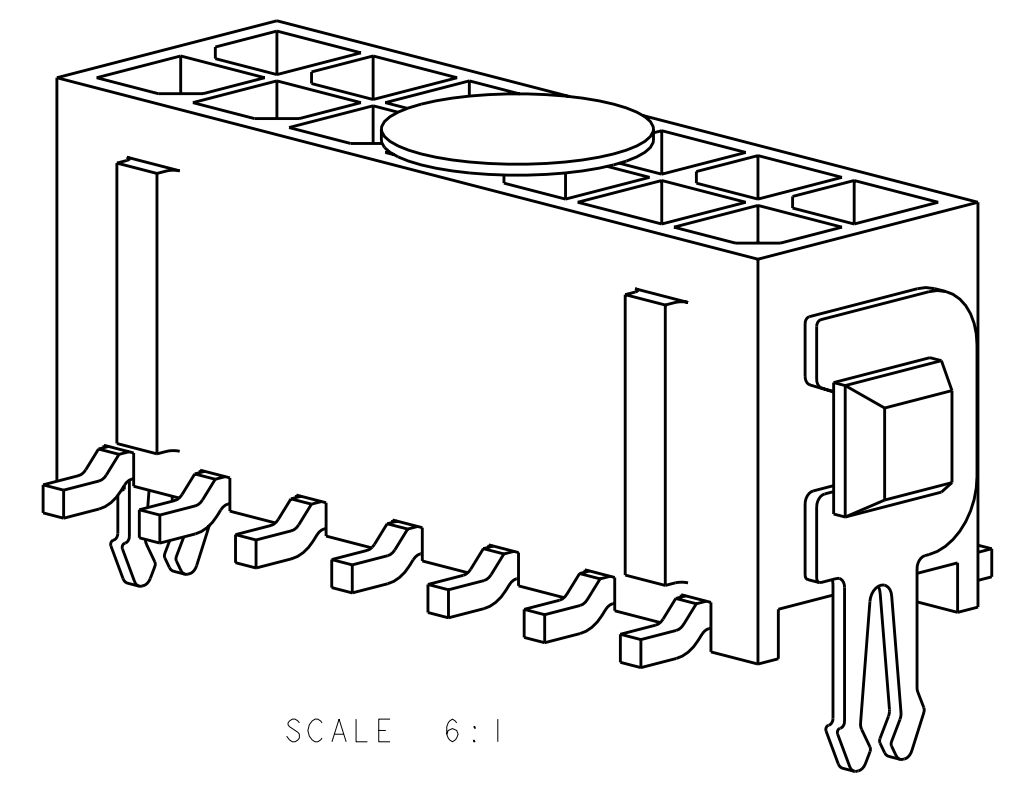

- 1 MATERIAL:
CONTACTS - BRASS.
HOUSING - UL 94V-0 RATED HIGH TEMP NYLON, COLOR; BLACK.
HOLDDOWNS - PHOSPHOR BRONZE.
- 2 PLATING:
CONTACTS - 0.76µm MINIMUM GOLD OVER 2.54µm MINIMUM NICKEL.
ON MATING AREA, 2.54µm TIN-LEAD MINIMUM OVER 2.54µm MINIMUM
ON SOLDER TAILS.
HOLDDOWNS - 2.54µm TIN-LEAD.
- 4 RECOMMENDED PC BOARD THICKNESS OF 1.57.
- 5 KAPTON VACUUM PICK UP BUTTON.
- 6 DIMENSION APPLIES TO SOLDER TAIL SURFACES
AND STANDOFF SURFACES.
- 7 ALL SOLDER TAILS.
- 8 PLATING:
CONTACTS - 0.76µm MINIMUM GOLD OVER 2.54µm MINIMUM NICKEL.
ON MATING AREA, 2.54µm MATTE TIN MINIMUM OVER 2.54µm MINIMUM
ON SOLDER TAILS.
HOLDDOWNS - 2.54µm MATTE TIN.

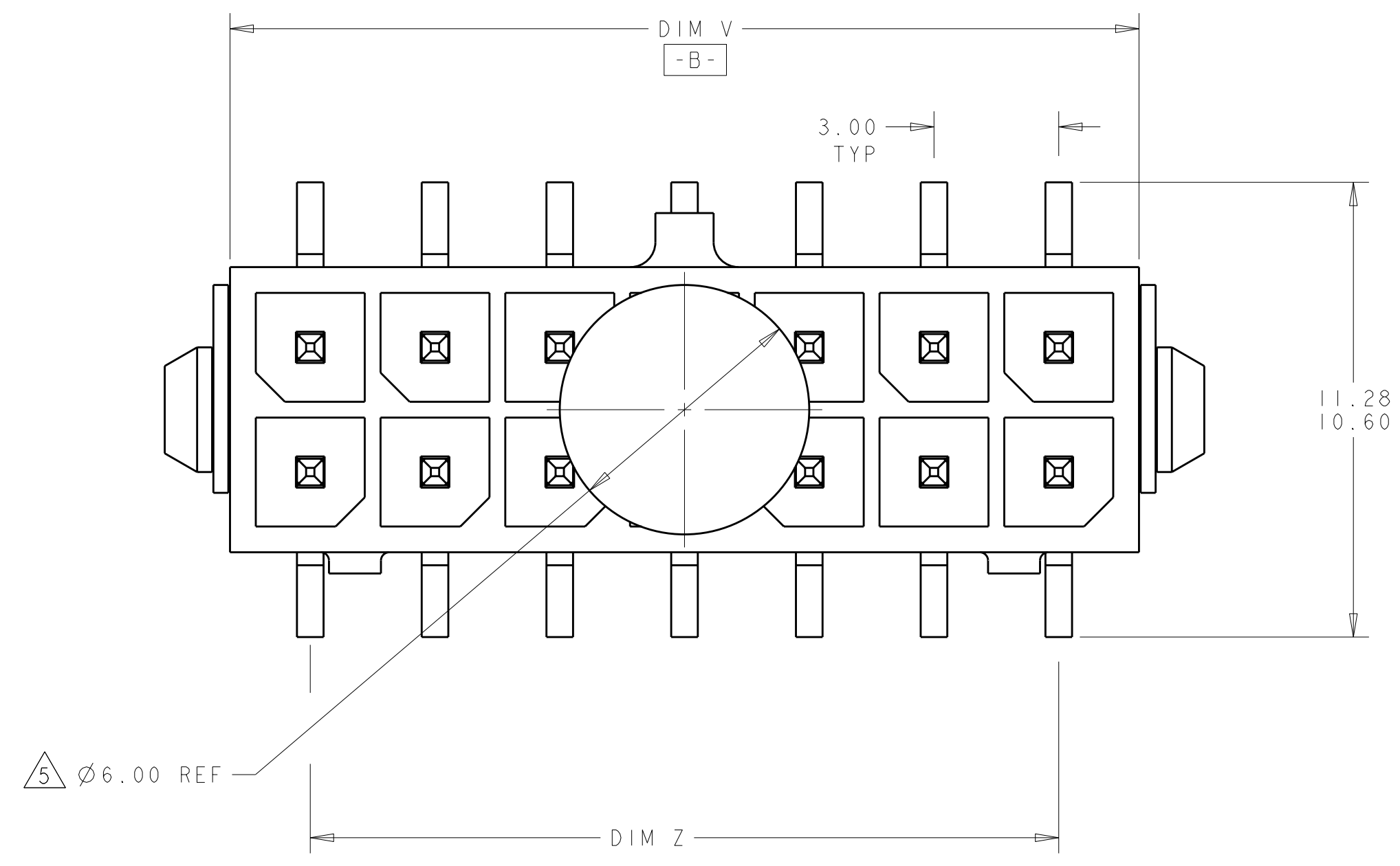
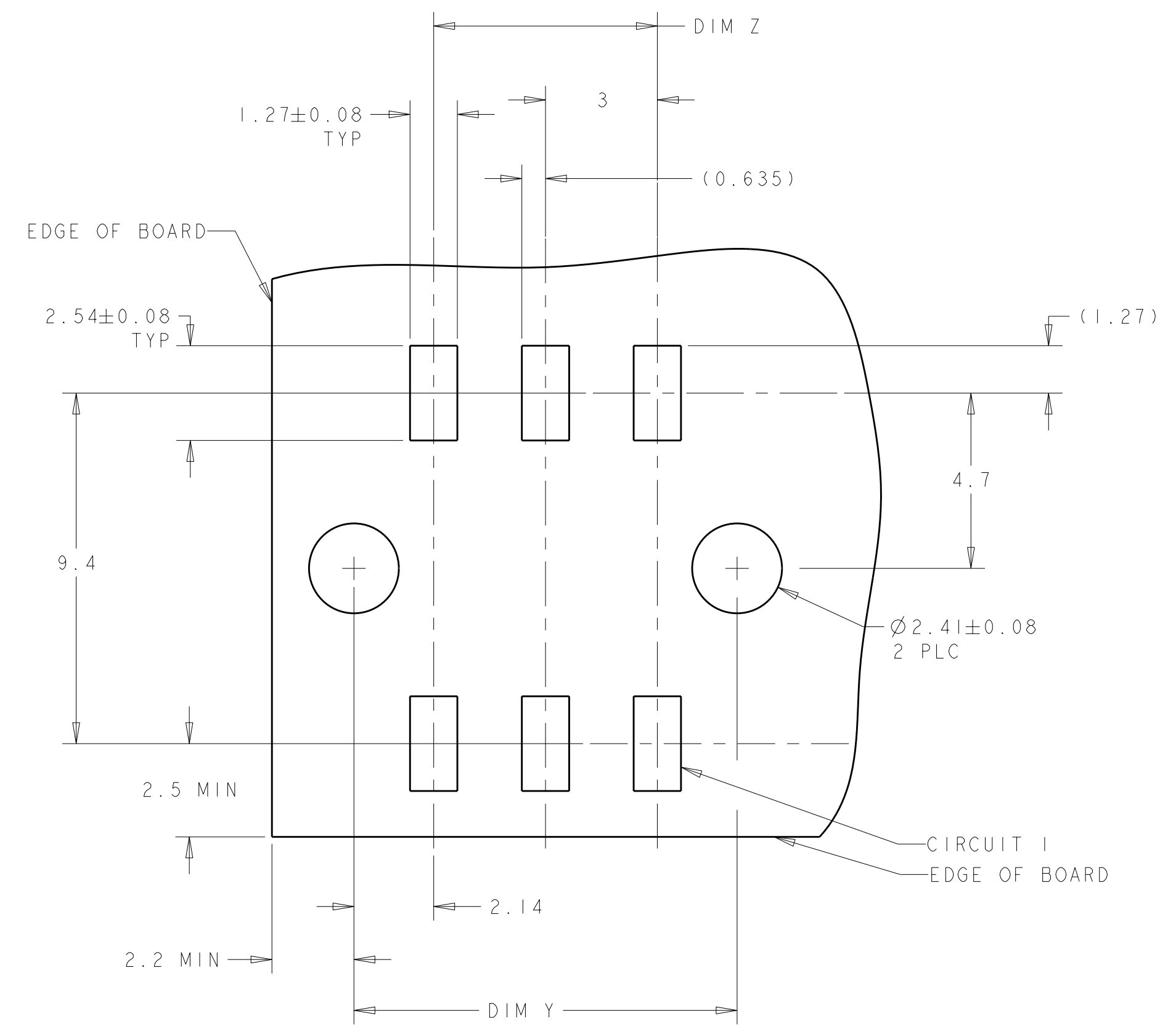
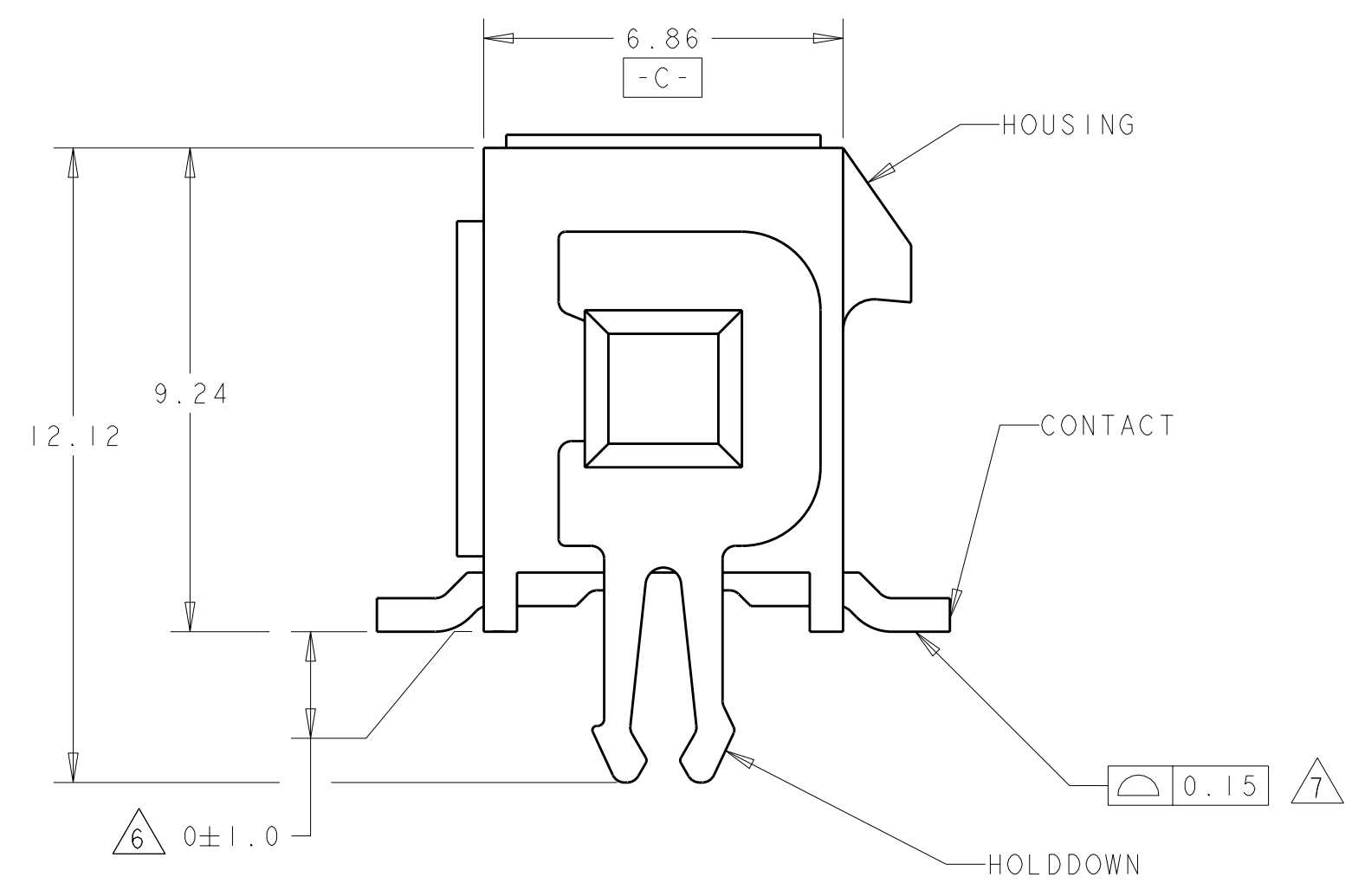
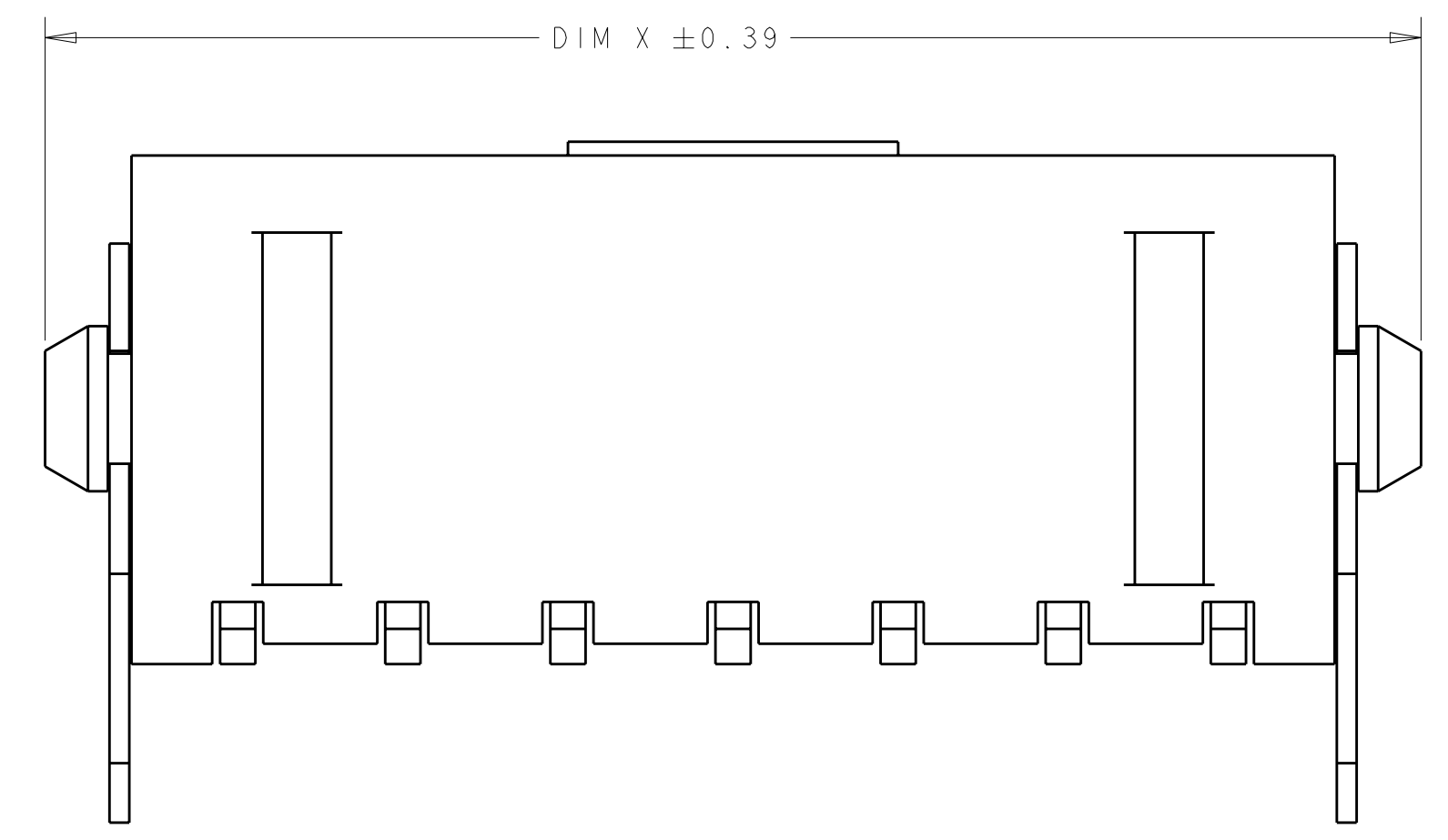

FINISH	DIM V	DIM Y	DIM Z	DIM X	NO. OF POSN.	PART NUMBER
8	36.86	37.30	33.00	40.00	24	5-794635-4
8	33.86	34.30	30.00	37.00	22	5-794635-2
8	30.86	31.30	27.00	34.00	20	5-794635-0
8	27.86	28.30	24.00	31.00	18	4-794635-8
8	24.86	25.30	21.00	28.00	16	4-794635-6
8	21.86	22.30	18.00	25.00	14	4-794635-4
8	18.86	19.30	15.00	22.00	12	4-794635-2
8	15.86	16.30	12.00	19.00	10	4-794635-0
8	12.86	13.30	9.00	16.00	8	3-794635-8
8	9.86	10.30	6.00	13.00	6	3-794635-6
8	6.86	7.30	3.00	10.00	4	3-794635-4
8	3.86	4.30	-	7.00	2	3-794635-2
2	36.86	37.30	33.00	40.00	24	2-794635-4
2	33.86	34.30	30.00	37.00	22	2-794635-2
2	30.86	31.30	27.00	34.00	20	2-794635-0
2	27.86	28.30	24.00	31.00	18	1-794635-8
2	24.86	25.30	21.00	28.00	16	1-794635-6
2	21.86	22.30	18.00	25.00	14	1-794635-4
2	18.86	19.30	15.00	22.00	12	1-794635-2
2	15.86	16.30	12.00	19.00	10	1-794635-0
2	12.86	13.30	9.00	16.00	8	794635-8
2	9.86	10.30	6.00	13.00	6	794635-6
2	6.86	7.30	3.00	10.00	4	794635-4
2	3.86	4.30	-	7.00	2	794635-2

METRIC

DIMENSIONS: mm TOLERANCES UNLESS OTHERWISE SPECIFIED: 9 PLC ± 1 PLC ± 5 PLC ±0.13 4 PLC ± ANGLES ± FINISH SEE TABLE		DWN: 19-MAR-2003 CHK: WHITAKER C: JONES APVD: C. JONES PRODUCT SPEC: APPLICATION SPEC: WEIGHT: CUSTOMER DRAWING		Tyco Electronics AMP Incorporated Harrisburg, PA 17105-3608 NAME: SURFACE MOUNT, VERTICAL, MECHANICAL HOLDDOWN, ASSEMBLY, 30 GOLD HEADER, DUAL ROW, MICRO MATE-N-LOK(TM) SIZE: CAGE CODE: DRAWING NO: A100779C=794635 SCALE: 8:1 SHEET 1 OF 1 REV H	
--	--	--	--	---	--